

EVODRUM

100% longer lifetime



The reusable Duplex Hub can be used twice.

- ✓ Main part of coupling can be used twice, saving costs

The housing is shipped from stock, cutting cost and procurement time.

- ✓ No manufacturing necessary
- ✓ No back and forth on confirmation drawings or the like
- ✓ Direct delivery

Available now for coupling sizes 5 to 112.

Q&A

How do you achieve a 100% longer lifetime?

The hub can be used twice, effectively doubling its lifetime.

Why do you need a 100% longer lifetime for a drum coupling?

This depends on your application and integration, particularly coupling alignment. Typical lifetimes range from 8 to 10 years, with some exceptions reaching up to 15 years. Considering sustainability, second-life usage, and equipment retrofits are becoming crucial in port operations. With this in mind, we have tailored this feature.

How can this be ordered?

Simply order TTXL 5-112 with the Duplex Hub option.

Does this option cost extra?

No, it does not.

What is necessary for integration into the drivetrain?

On the hub side, it can be connected using standard keyway connections. Important: Ensure a clearance fit between the motor shaft and hub (as opposed to an interference fit). This typically requires a double keyway connection, which has been standard in the past. On the housing side, everything remains the same.

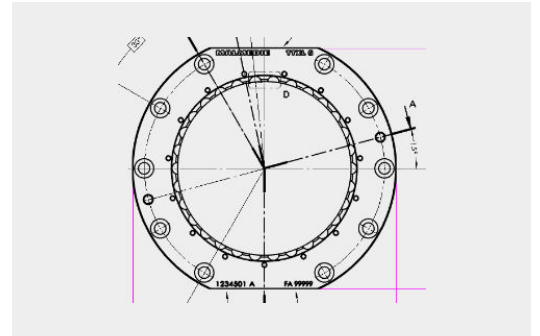

665051 (Drawing of 6-unit housing)

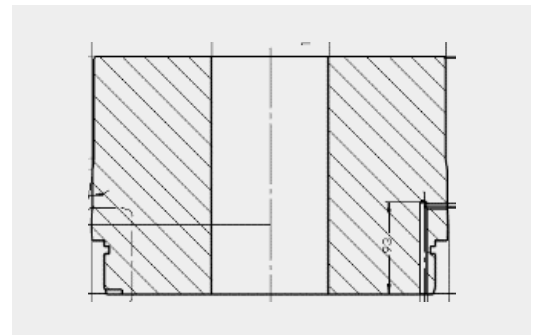

665031 (Drawing of 6-series standard hub)

LIFEMONITOR

Continuous wear monitoring with up to 0,1mm increments



MALMEDIE® Couplings sizes 5 to 112 can now be upgraded with the LifeMonitor option.

- ✔ No need to perform an in-person visual or tactile inspection of wear.
- ✔ Continuous logging in 0,1mm increments and indication of remaining wear.
- ✔ Allows for visualization of wear over time.

For STS and shipunloaders, up to 8 sensors can be attached to one LifeMonitor.

- ✔ Wear can be checked in one location
- ✔ Data can be transferred via numerous means (Profibus, Profinet, CANopen, MQTT, analoguous (0/4-20mA), VPN, LAN
- ✔ IP65 housing

Case Study / Field Experience on an STS main hoist: Get your service!

● right coupling ● left coupling

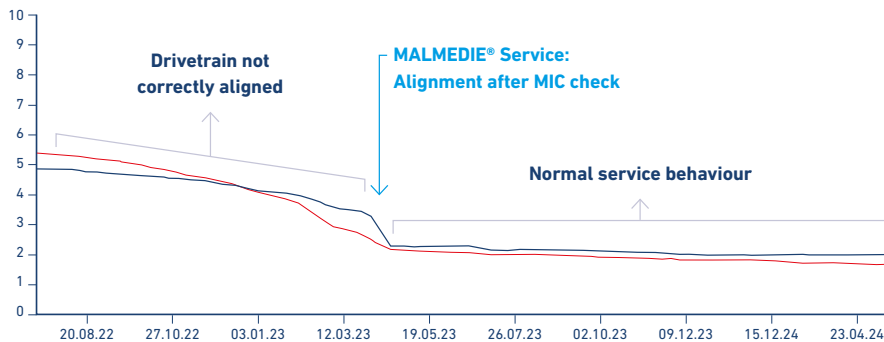

Q&A

How can this be ordered?

Simply order TTXL 5-112 with the LifeMonitor option.

Does this option cost extra?

Yes. First customers will receive preferential pricing.

How much space is needed for installation?

A gap of 100mm between the coupling housing and gearbox is needed.

Is this option also available for existing hoists in the field?

Depending on the project and crane, both MALMEDIE® couplings and couplings from generic brands can be retrofitted with this feature.

**WE DRIVE THE FUTURE.
MALMEDIE.COM**